

# NEXIS CLICK-ON 22

110° hinge



- 110° opening angle
- Soft-close compatible
- With shallow cup depth (11 mm) also suitable for soft-formed doors
- 3-dimensional adjustment with appropriate mounting plate

## Available in 2 versions:

- With self-closing mechanism (spring)
- Without self-closing mechanism (spring) for use with Tipmatic

## ORDER INFORMATION

| Door overlay |  | Material             |                      | Cranking | with spring | Item No.              |                        |
|--------------|--|----------------------|----------------------|----------|-------------|-----------------------|------------------------|
|              |  | Cup                  | Arm                  |          |             | Click-on Screw fixing | Click-on Press fitting |
| Full overlay |  | Steel, nickel-plated | Steel, nickel-plated | 0        | ■           | <b>F015072811</b>     | <b>F015072810</b>      |
|              |  |                      |                      |          | –           | <b>F015072816</b>     | –                      |
| Half overlay |  | Steel, nickel-plated | Steel, nickel-plated | 8        | ■           | <b>F015072818</b>     | <b>F015072817</b>      |
|              |  |                      |                      |          | –           | <b>F015072819</b>     | –                      |

## COVER CAPS

|  | Designation  | Cranking | Imprinted/Embossed | Item No.          |
|--|--|----------|--------------------|-------------------|
|  | Hinge arm cover cap, steel, short, nickel-plated, not imprinted, Soft-close compatible | 0        | On request         | <b>F069073570</b> |
|  | Hinge arm cover cap, steel, open, nickel-plated, not imprinted, Soft-close compatible  | 8        | On request         | <b>F069073669</b> |

## ACCESSORIES

|  | Designation                | Item No.          |  | Designation  | Item No.          |
|--|----------------------------|-------------------|--|--|-------------------|
|  | Tipmatic Plus Click-on set | <b>F069073752</b> |  | 85° opening angle reduction clip plastic, black          | <b>F069135032</b> |
|  | Soft-close Click-on set    | <b>F069073714</b> |  | Hinge cup cover cap, steel, nickel-plated, not imprinted | <b>F069073687</b> |

|                                |     |
|--------------------------------|-----|
| Nexis Click-on mounting plates | 272 |
| Accessories                    | 280 |

|                        |     |
|------------------------|-----|
| Soft-close Click-on    | 340 |
| Tipmatic Plus Click-on | 356 |

|                       |     |
|-----------------------|-----|
| Technical information | 282 |
| Assembly aids         | 808 |

## INSTALLATION INFORMATION

All dimensions in millimetres

Full overlay K0

Mounting plate height 2

| Door overlay | 0  | Cup distance |   |   |   |   |  |
|--------------|----|--------------|---|---|---|---|--|
|              |    | 3            | 4 | 5 | 6 | 7 |  |
|              | 20 |              |   |   |   | 0 |  |
|              | 19 |              |   |   | 0 |   |  |
|              | 18 |              |   | 0 |   | 2 |  |
|              | 17 |              | 0 |   | 2 | 3 |  |
|              | 16 | 0            |   | 2 | 3 | 4 |  |
|              | 15 |              | 2 | 3 | 4 |   |  |
|              | 14 | 2            | 3 | 4 |   |   |  |
|              | 13 | 3            | 4 |   |   |   |  |
|              | 12 | 4            |   |   |   |   |  |
|              |    |              |   |   |   |   |  |

Mounting plate height

Half overlay K8

Mounting plate height 2

| Door overlay | 8  | Cup distance |   |   |   |   |  |
|--------------|----|--------------|---|---|---|---|--|
|              |    | 3            | 4 | 5 | 6 | 7 |  |
|              | 12 |              |   |   |   | 0 |  |
|              | 11 |              |   |   | 0 |   |  |
|              | 10 |              |   | 0 |   | 2 |  |
|              | 9  |              | 0 |   | 2 | 3 |  |
|              | 8  | 0            |   | 2 | 3 | 4 |  |
|              | 7  |              | 2 | 3 | 4 |   |  |
|              | 6  | 2            | 3 | 4 |   |   |  |
|              | 5  | 3            | 4 |   |   |   |  |
|              | 4  | 4            |   |   |   |   |  |
|              |    |              |   |   |   |   |  |

Mounting plate height

## MINIMUM GAP

|                |              |     |     |     |     |     |
|----------------|--------------|-----|-----|-----|-----|-----|
| Door thickness | Cup distance |     |     |     |     |     |
|                |              | 3   | 4   | 5   | 6   | 7   |
|                | 16           | 0.5 | 0.6 | 1.6 | 2.6 | 3.6 |
|                | 18           | 0.5 | 1.2 | 2.2 | 3.2 | 4.2 |
|                | 19           | 0.5 | 1.5 | 2.5 | 3.5 | 4.5 |
|                | 20           | 0.8 | 1.8 | 2.8 | 3.8 | 4.8 |
|                | 22           | 1.4 | 2.4 | 3.4 | 4.4 | 5.4 |
| Minimum gap    |              |     |     |     |     |     |

## MINIMUM REVEAL

|                    |              |     |     |     |     |     |
|--------------------|--------------|-----|-----|-----|-----|-----|
| Door thickness     | Cup distance |     |     |     |     |     |
|                    |              | 3   | 4   | 5   | 6   | 7   |
|                    | 16           | 0.5 | 0.5 | 0.5 | 0.5 | 0.5 |
|                    | 18           | 1.0 | 1.0 | 1.0 | 1.0 | 1.0 |
|                    | 19           | 1.2 | 1.2 | 1.2 | 1.2 | 1.2 |
|                    | 20           | 2.2 | 1.5 | 1.5 | 1.5 | 1.5 |
|                    | 22           | 4.7 | 3.7 | 2.8 | 2.1 | 2.1 |
| Minimum reveal (F) |              |     |     |     |     |     |

## NOTES

The minimum gap is the clearance required between the front edge of the cabinet and the closed door so that the door can open without hindrance.

**Important:** Reveals were calculated for doors with a radius of 1 mm!

Hinge dimensions and reveal calculation with factory setting.

We recommend a trial fitting.

## DRILLING PATTERNS

### Screw fixing

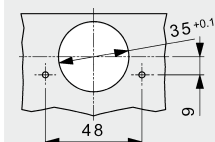

### Press fitting

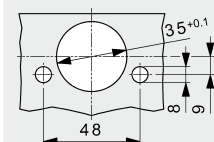

## CUP DIMENSIONS

